



ENABLING THE DIGITAL THREAD IN MARINE & OFFSHORE

JAN BITOMSKY
TAM SHIPBUILDING INDUSTRY
JAN.BITOMSKY@PROSTEP.COM



We are

- an **independent** company specializing in PLM consultancy services and engineering solutions.
- **experts** in providing leading global manufacturing companies with the support they require for designing and optimizing their internal and cross-enterprise **development processes**.
- the **specialist** for distributed engineering processes involving **heterogeneous** IT systems.

The PROSTEP Group



More than 25 Years Experience - 230 PLM Experts - 200 Customers - 12 Locations

- Founded in 1993

- Offices

Darmstadt (headquarter)

Berlin, Hamburg, Hanover, Cologne,
Munich, Saarbrücken,
Sindelfingen, Stuttgart, Wolfsburg

USA: Troy (MI)

Poland: Wrocław

- Revenues Group: ca. 42,7 Mio. €
- 290 Employees
- TOP-shareholders:



Mercedes-Benz AG

• APTIV •



SIEMENS

VOLKSWAGEN
AKTIENGESELLSCHAFT





PROSTEP

We speak Shipbuilding, IT & Business

- ✓ Strategy Consultancy
- ✓ Concept & Solution Consultancy
- ✓ Implementation of IT & Process
- ✓ PLM/IT-Integration as a Standard Product

Shipbuilding-related PLM Vendor Partnerships

AUTODESK

AVEVA



SIEMENS

SSI DASSAULT SYSTEMES

pema
WELDING AUTOMATION

SAP nestix»

CADMATIC
SOFTWARE SOLUTIONS

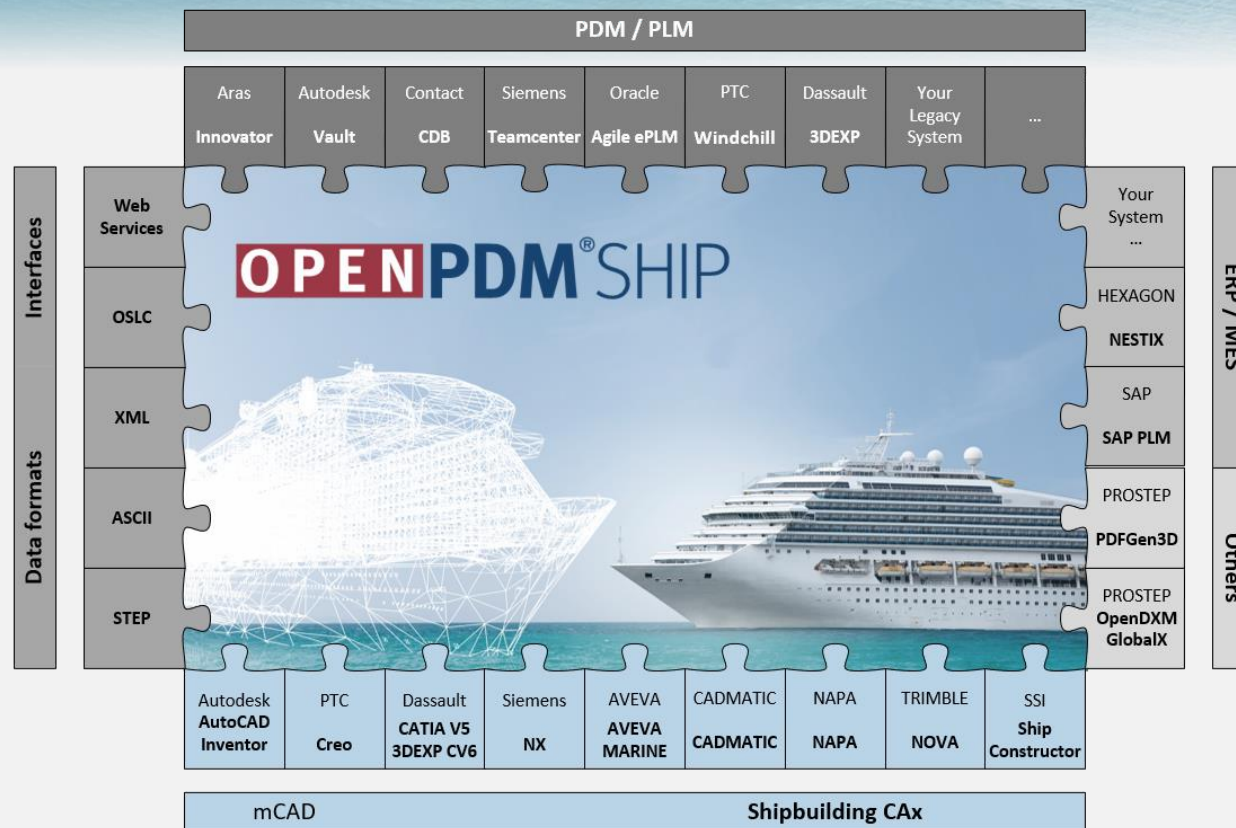

Customers

FASSMER

ThyssenKrupp

ThyssenKrupp Marine Systems

LÜRSSEN

HYUNDAI
HEAVY INDUSTRIES CO., LTD.

MV
WERFTEN
WISMAR · ROSTOCK · STRALSUND

AUSTAL

HELSENKI
SHIPYARD

aselsan

DNV·GL

ULSTEIN[®]

ABS

nestix»

ULSTEIN[®]

GERMAN NAVAL
YARDS KIEL

Keppel

FELS

SWS

MEYER

ND Coatings

MAC Hamburg
MARINE AIRCONDITIONING CENTRES

MEYER WERFT
PAPENBURG 1792

NEPTUN WERFT
ROSTOCK 1810

MEYER TURKU
SHIPYARD 1937

Project References in Marine & Offshore

Projects Reference – Strategy Consulting

Development of PLM Architecture and Roadmap

Largest privately owned shipyard in AUSTRALIA with subsidiaries in Philippines & Vietnam and a Sister Company in the US seeking to enhance its PLM capabilities to become more efficient and ensure compliance in defense projects

Project Goal

Recommend AUSTAL's future PLM architecture to address business challenges and provide a roadmap aligned to this.

Objectives

- PLM improvement topics to address the business needs
- PLM architecture options
- PLM road map for the implementation



PROSTEP

AUSTAL



Projects Reference – PLM Implementation

Implementation of Siemens Teamcenter as Part of the Enterprise PLM Platform

Shipyard group with 3 build locations in northern Germany owned by cruise operator GENTING seeking to improve its PLM capabilities to develop and build world's largest cruise ship

Project Goal

Provide Teamcenter based PLM capabilities to business and improve & empower product development processes to build 3+ new types of cruise ships

Objectives

- Identify and coordinate business requirements with Engineering, Procurement, Manufacturing experts
- Implement TC as SaaS solution and adopt to shipyard needs
- Integrate TC with NAPA and AVEVA
- Integrate TC with legacy ERP
- Migrate legacy DMS to TC
- Integrate AVEVA and TC with legacy manufacturing tool environment



PROSTEP

MV WERFTEN



Project Reference – Partner Collaboration

Collaboration with engineering service suppliers

Customer Use Cases

- Meyer Werft is one of the leading yards for cruise liners. The company is especially known due to the construction of huge, modern and sophisticated cruise ships.
- They rely on an extensive network of design partners.
- CAD data exchange with yard standards, reference geometry and design work needs to be reliable, traceable and secure

Collaboration Solution

- The file vaults inside MW and at the partners are connected using OpenPDM CCenter
- A dedicated web application enables the business to decide which structures needs to be send to which supplier and trace the status
- Automatic structure investigation ensure that all needed files are send, delta mechanism reduce the exchange volume



PROSTEP

MEYER WERFT



Projects Reference – Paperless Processes

Digital Class Approval

Implement 3D Class Approval based on Digital Data Packages

Lightweight Formats transferring only the needed information

Digital Annotation and Signature

- No additional software required for data consumption
- PDF – Adobe Reader
- HTML5 – Web Browser

development supported by

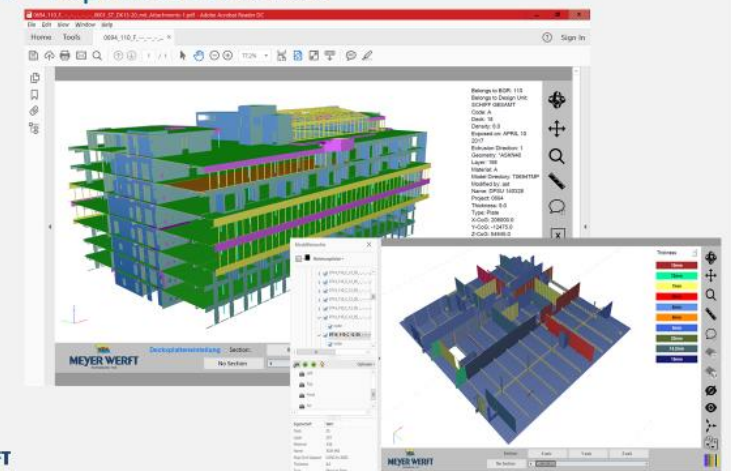

SHIPBUILDING PLM INSIGHTS

<https://www.prostep.com/en/online-events/prostep-shipbuilding-plm-insights.html>

„PROSTEP SHIPBUILDING PLM INSIGHTS“ is a series of online sessions to illustrate our findings to the various challenges shipyards today encounter worldwide in their efforts to increase model-based development, collaboration and traceability in their ship development processes.

PLM is a topic for both, business and IT - in shipbuilding just like any other manufacturing industry. You will have the unique chance to hear our insights from recent activities with our clients from all over the world.

PROSTEP SHIPBUILDING PLM INSIGHTS



EPISODE 2 JUNE 1, 2021

Complex products, reduced time to market, increasing customer and classification requirements, and finally a world economy disturbed by Corona pandemic are just a few challenges all shipbuilders around the globe are facing today. Often, these very high demands cannot be sufficiently fulfilled by traditional infrastructure at shipyards.

- How can a PDM system improve this situation?
- What is the difference between PDM and PLM?
- How does PDM relate to ERP?
- How can traceability of decision processes be ensured?

These and many more questions will be addressed in our series of Shipbuilding PLM Insight episodes.

Episode 2 – Shipyard Collaboration, June 1, 2021

In the second episode, PROSTEP will take a more detailed look into typical collaboration models in the shipbuilding industry and share some insights, that we have learned from working with a multitude of customers in the context of collaboration.

As you probably know, working with reliable partners is mandatory in modern times. However, the collaboration can pose some processual, organizational, and technical challenges and increases the complexity by adding another dimension.

That is why we want to talk about processes, that typically become more complex with partners and share some tricks and questions, that you should keep in mind and ask yourself the next time you think about collaboration.

Contact

Oliver Lortz
Tel.: +49 (0) 6151 9287 369
E-Mail: oliver.lortz@prostep.com

SHIPBUILDING PLM INSIGHTS
Register now!

Time
8:00 am - Duration 40 Minutes [Calendar entry]
OR
5:00 pm - Duration 40 Minutes [Calendar entry]

PROSTEP SHIPBUILDING PLM INSIGHTS



EPISODE 1

Episode 1 – The Interaction of CAD and PDM in Shipbuilding

Recording from March 16, 2021

In this video you will discover how a PDM system can improve the high demands of shipyards, the difference between PDM and PLM and how PDM relates to ERP. It also explains how to ensure traceability of decision processes in shipbuilding.

Contact

Matthias Grau
Tel.: +49 (0)178 9509 416
E-Mail: matthias.grau@prostep.com

Jan Bitomsky
Tel.: +49 (0)160 9258 3975
E-Mail: jan.bitomsky@prostep.com

shipbuilding.prostep.com

The PROSTEP logo is located in the top left corner. It features the word "PROSTEP" in a bold, blue, sans-serif font. A small red horizontal bar is positioned to the left of the letter "P".

PROSTEP

THANK YOU!

PROSTEP AG

Dolivostraße 11
64293 Darmstadt
Germany
Telefon +49 6151 9287-0
Telefax +49 6151 9287-326
E-Mail info@prostep.com

PROSTEP, Inc.

300 Park Street, Suite 410
Birmingham, MI 48009
USA
US Toll Free Voice
8 PROSTEP 01 (877 678-3701)